

◆ IPS 32-Agilent Medalist Test Handler

The CRS-Test Handler is designed for the Test system Agilent 327x and Medalist i5000. It is equipped with the following functions and features:

- ✓ Probe Force 4000 N
- ✓ Double side probing
- ✓ Test pad D > 0,7mm
- ✓ Dual stage fixtures
- ✓ Test jet application
- ✓ Short Wire fixture
- ✓ Easy and quick fixture change
- ✓ Compact Fixture Kit
- ✓ Integrated Barcode reader
- ✓ Easy maintenance for test system
- ✓ Operator Panel

The IPS 32 is specially designed to save space in your production line.

The Test system is full integrated under a bridge construction.

Mode of Operation:

The PCB's are buffered on one separate conveyors with integrated barcode reader.

After reading the barcode, the board moves into the contact area. The contacting unit consists of a two spindle servo drive.

The main advantages of the spindle servo drive is the free choice of the traverse path and the contacting speed depending on the PCB.



*Test Handler IPS 32-Agilent Medalist
with operator panel*

Furthermore is a multilevel contacting without extra costs possible.

The special fixture design offers the basis for many additional applications. For example both side contacting, test jet, alignment tools and many others.

After the Test the board moves to the next conveyor for the next process.

Additional options:

- ✓ PCB Turning unit
- ✓ Automated Pass marking with ink stamp
- ✓ Automated Pass marking with scratch
- ✓ X/Y-axis Pass marking
- ✓ Contact from topside with separate movement. No Pin contact from top before the board is in the exact position
- ✓ Pass - Fail sorting
- ✓ Data matrix optional
- ✓ Automated conveyor width adjustment

We test it

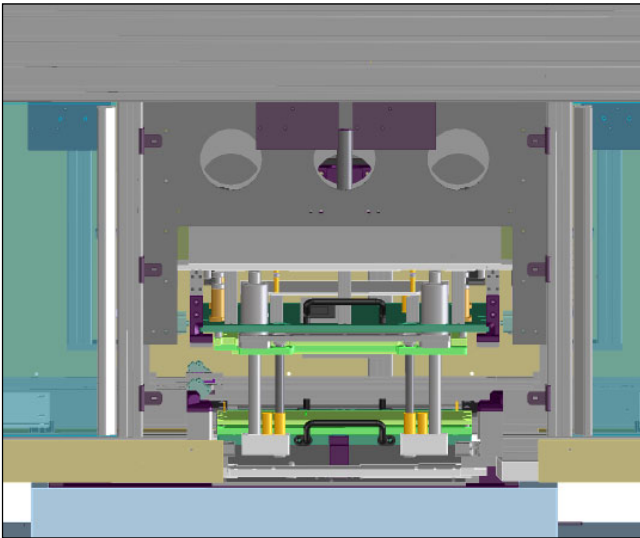

Test Handler IPS 32-Agilent Medalist, Contact area with fixture

Technical Details:

Max. Dimensions PCB:	360 x 400 mm
Max. Components height:	50 mm
Max. Height solder side:	15 mm
PCB-Conveyor area:	2 x 3 mm
Distance tooling pin to the PCB-outlines:	4 mm + ½ d-Tooling pin
Testpad:	D > 0,7 mm
Grid:	≥ 1,27 mm (50 mil)
Testprobes:	Standardprobes for 100/75/50 mil Installation height 10 - 22 mm
Fixture:	- Agilent SimPlate Expresskit (without Vacuum tools) - CRS Upgrade kit
Max. Probeforce:	4000 N
Fixture drive:	2 point spindle, multilevel
PLC:	Siemens S7 Bosch-Rexroth L40 with operator panel
min. Dimension machine:	L 1500 x W 1000 x H 1893 mm
Length extension for two modul Testsystem possible !	

CRS Prüftechnik GmbH

Torenstraße 15
88709 Meersburg
Germany
Tel. +49(0)75 32/4 71 89
Fax +49(0)75 32/16 54
info@crs-prueftechnik.de
www.crs-prueftechnik.de

The communication between Test system and Test handler is via RS 232.

With the serial Interface have both components an ideal connection, which assures an easy and safe operation.

Support: Worldwide possible with partners.

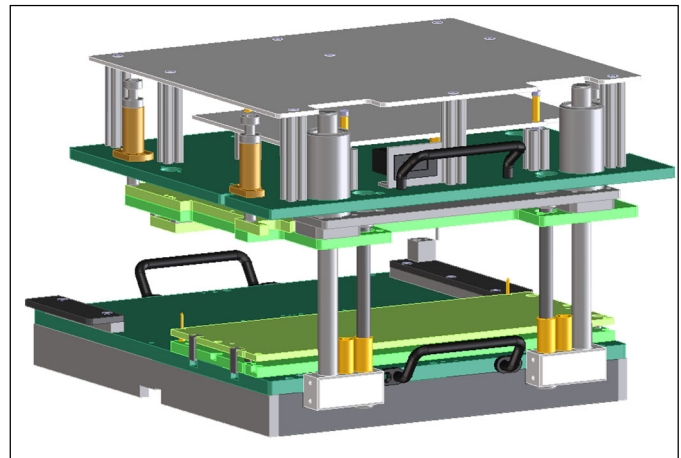

Fixture Kit 3070

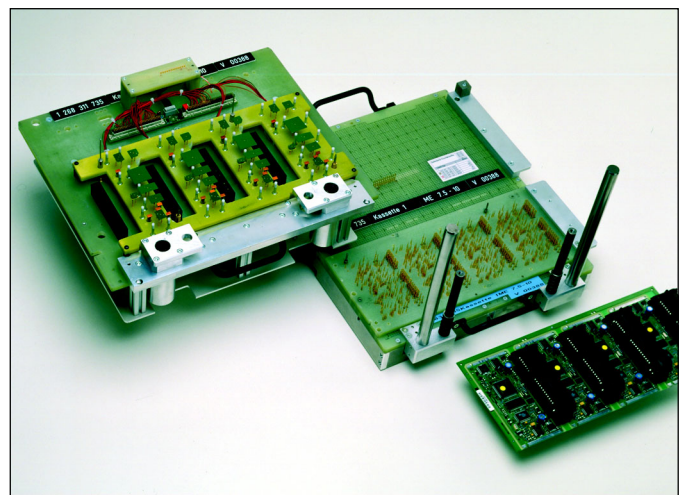

Fixture Agilent 3070, fixture bottom needle bed with open down holder plate